

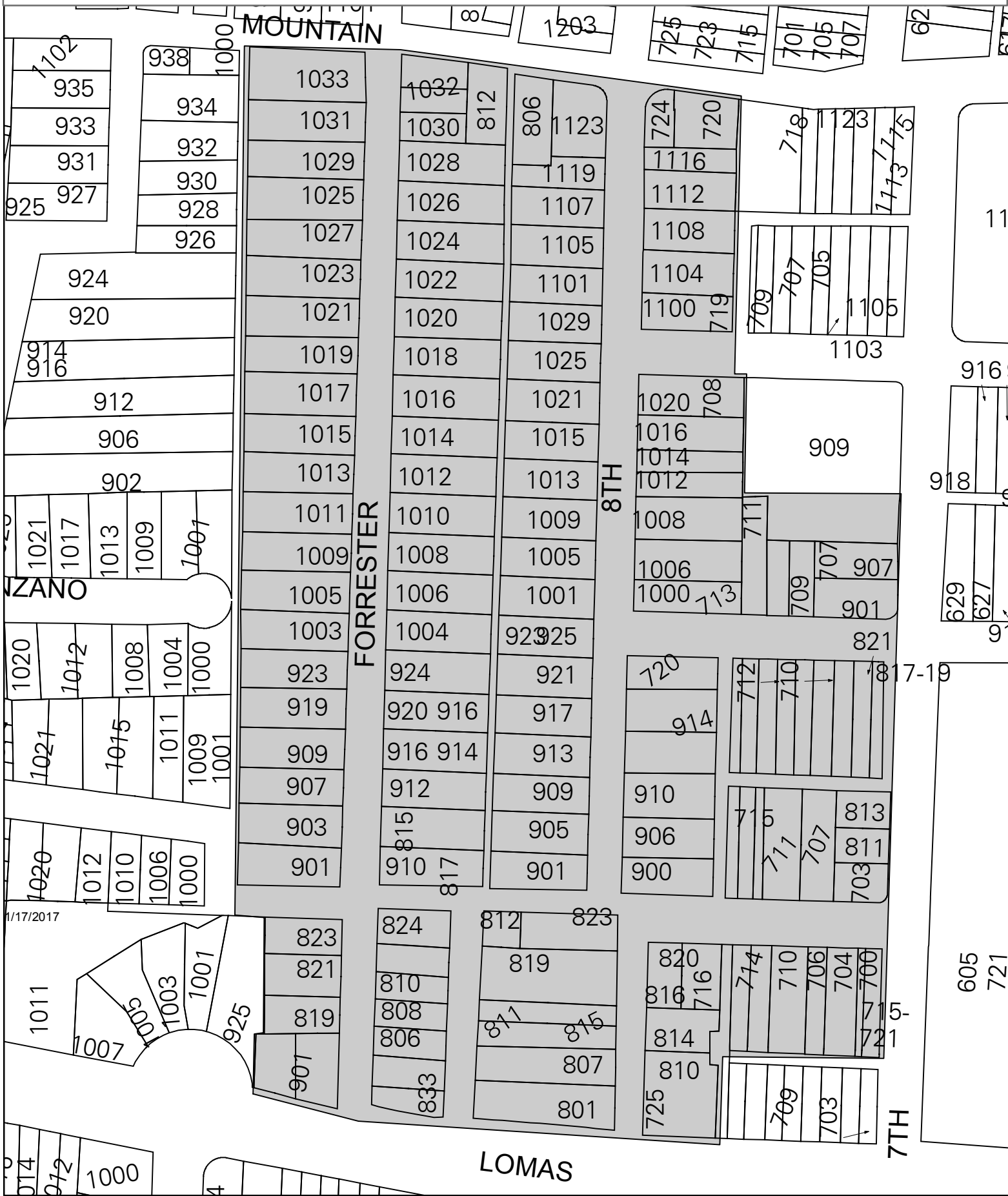

8TH/FORRESTER HISTORIC OVERLAY ZONE

Note: Landmarks & Urban Conservation
Commission approval is required
before work begins in Historic Zones

Date: 1/17/2017

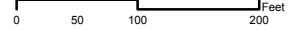

1/17/2017

LOMAS

7TH

MOUNTAIN

FORRESTER

8TH

VIZANO

605
721

629
627

918

916

11

62

725
723
715

701
705
707

938
1000
934
932
930
928
926

1102
935
933
931
925 927

1033
1031
1029
1025
1027
1023
1021
1019
1017
1015
1013
1011
1009
1005
1003
923
919
909
907
903
901

1032
1030
1028
1026
1024
1022
1020
1018
1016
1014
1012
1010
1008
1006
1004
924
920
916
912
909
905
901

812
806
1123
1119
1107
1105
1101
1029
1025
1021
1015
1013
1009
1005
1001
923
921
917
913
909
905
901

724
720
1116
1112
1108
1104
1100
719

718
1123
1113
1115
709
707
705
1105
1103

1020
1016
1014
1012
1008
1006
1000
713

708
909
711
707
907
901
821

720
914
910
906
900

712
710
715
711
707
813
811
703

1011
1007
1003
1001
925
901
823
821
819
810
808
806
833
807
801

823
821
819
810
808
806
833
807
801

824
812
819
817
815
807
801

823
820
816
814
810
725
714
710
706
704
700
715
709
703

820
816
814
810
725
714
710
706
704
700
715
709
703

817-19