



CITY OF ALBUQUERQUE

Planning Department

Building Safety

COVERED PATIOS, PORCHES AND CARPORTS

Plans & Permit Information

Submit two (2) sets of plans. Plans shall be drawn to scale upon substantial paper and shall be of sufficient clarity to indicate the nature and extent of the work proposed and show in detail that it will conform to the provisions of the Technical Codes and all relevant laws, ordinances, rules and regulations (UAC 110.3). Provide plan views at a minimum of 1/4"=1'-0" scale and provide sections and details at a minimum of 1/2"=1'-0" scale.

All metal / aluminum frame construction plans must be certified by a registered New Mexico professional engineer.

When plan review is complete the designee will be notified by telephone. Please arrange to have a contact person, telephone and extension number listed on the application. Comments are available on line at <http://www.cabq.gov/planning/our-department/building-safety> : Quick Links [Plan Review Comments](#) or call 505-924-3320.

The building permit will be issued when approved by each division. The permit will only be issued to a homeowner or general contractor (GB-2 or GB-98) licensed in the State of New Mexico. If the building permit is not issued within six (6) months from the date of submittal, the application will expire.

ADOPTED CODES: The following codes are a minimum standard and base guideline for building construction.

- 2015 International Residential Code (IRC)
- 2009 International Energy Conservation Code (IECC)
- 2015 New Mexico Existing Building Code (NMEBC)
- 2014 National Electrical Code (NEC)
- 2017 Albuquerque Uniform Administrative Code (UAC)

Design Criteria

UAC - Table 301.2(1)

Ground Snow Load	Wind Speed (MPH)	Rainfall	Seismic Design Category	Subject to Damage From			Winter Design Temp	Ice Shield Under-Layment Required	Air Freezing Index	Mean Annual Temp
				Weathering	Frost Line Depth	Termite				
20	115*	2" per hour	C	Moderate	16"	Moderate to Heavy	12° F	N/A	263	54.6

* 3 second gust

One-hour fire resistive construction required for carports, covered patios & porches less than 5 feet of a property line.

The plans shall include the following data:

Site Plan

- Actual site address of project
- Provide location and dimensions of proposed construction, existing buildings, distances between buildings/structures and to the property lines
- Label all streets, easements and setbacks
- Size and shape of Lot with north arrow
- Provide property line dimensions/coordinates
- Driveway width including curb cut
- All required off-street parking
- Grading and drainage information

Roof Framing Plan

- Type, size and spacing of all framing members including: trusses, joist, girders, rafters, beams, posts and all mechanical connectors
- Size and locations of all posts and headers
- at all openings, doors and windows
- Grade and species of all structural lumber
- Signed and sealed truss drawings with a New Mexico Licensed Engineer's seal/stamp

Wall Section Plan

- Bearing wall section details
- Roof slope and finished materials
- Grade and species of all structural lumber
- Dimensions, type, size, location and depth below grade of all footings, piers; stem walls, size and spacing of steel reinforcement
- Indicate all wall/roof finishes and materials
- Indicate minimum wood to earth separation
- Roof joists and rafters – size and spacing
- Wall anchorage to footing

Electrical Plan (If needed)

- Location of receptacles, switches, lights, thermostat(s), smoke and carbon monoxide detectors, ventilating fans, and exhaust fans
- Arc fault circuit and ground fault circuit interrupter outlets where required

Inspections:

Inspection Section: Permit number is required for all inspection requests. For inspections call: **(505) 924-3320**

Building Inspections

- Foundation/Footing Inspection
- Insulation (Call before pour)
- Framing Inspection (seismic if required)
- Exterior Lath Inspection
- Wall insulation inspection
- Wall Board Inspection (firewalls, shear walls and fire stop systems if required)
- Final Inspection

Electrical Inspections

- Low-Voltage Inspection
- Final Inspection

DISCLAIMER: Handouts should not be used as substitutes for codes and regulations. As an applicant, you are responsible for compliance with all code and rule requirements, whether or not they are described in a handout. The required drawings will depend upon the size, nature and complexity of the project.

Please use the following examples for reference

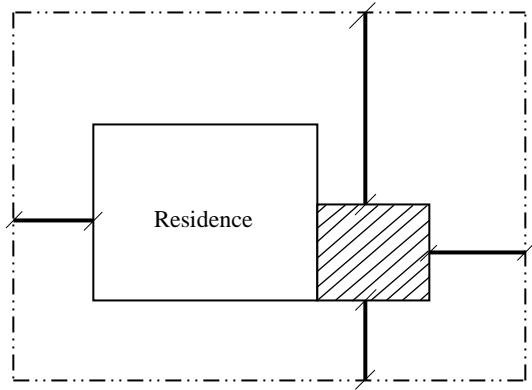

ROOF PLAN

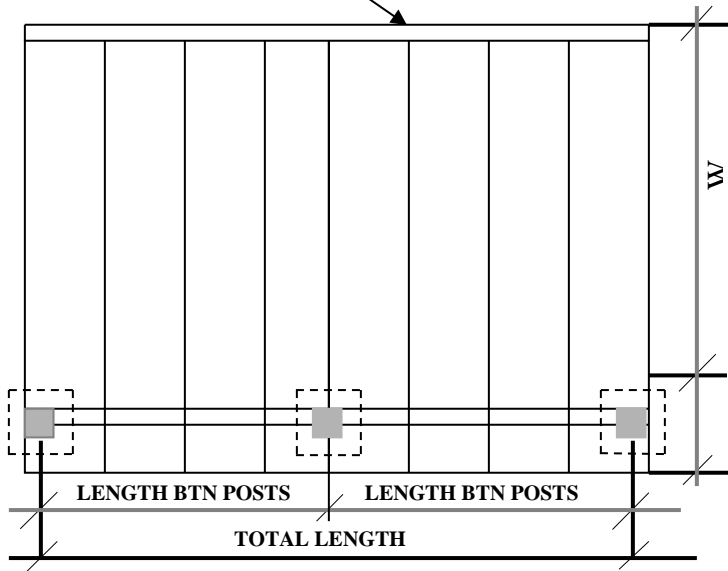

Show scale of dwg

Figure No. 2

WALL SECTION

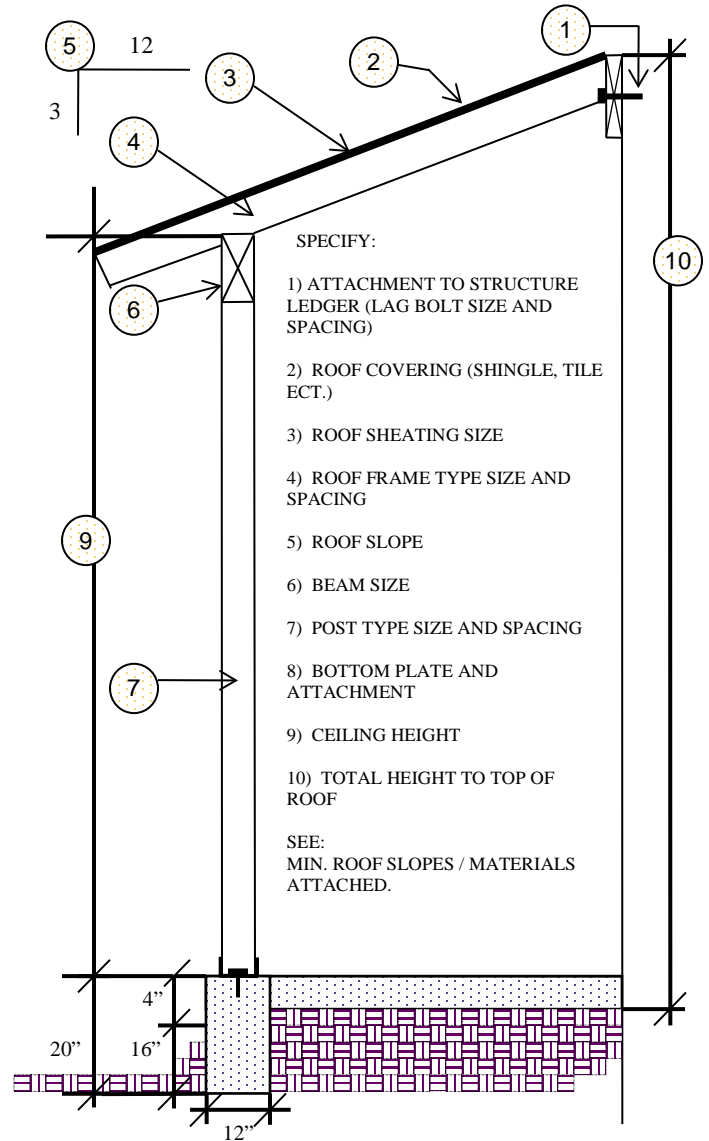

Show scale of dwg